

Top View of Assembly

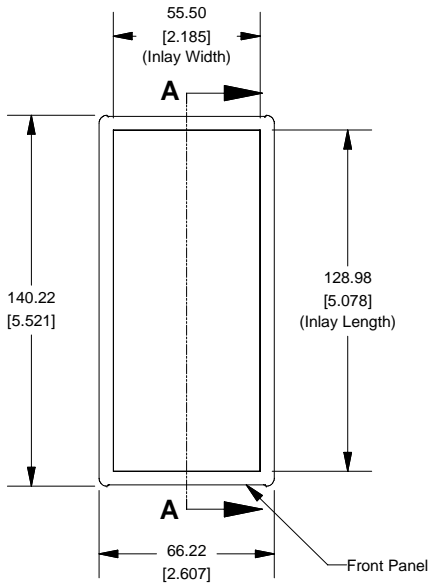

SECTION A-A (Side View Inside Assembly)

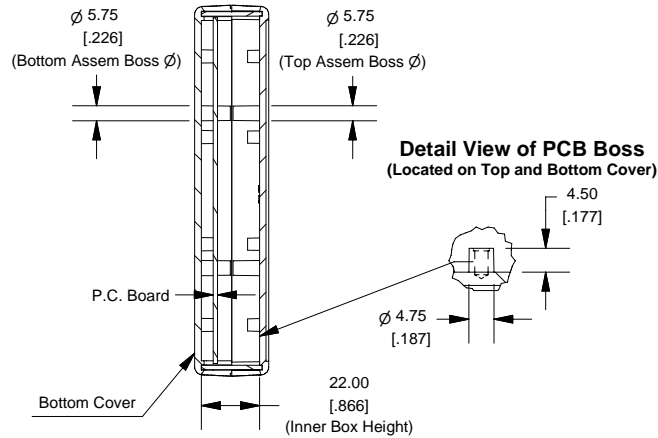

SECTION B-B (Inside of Bottom Cover)

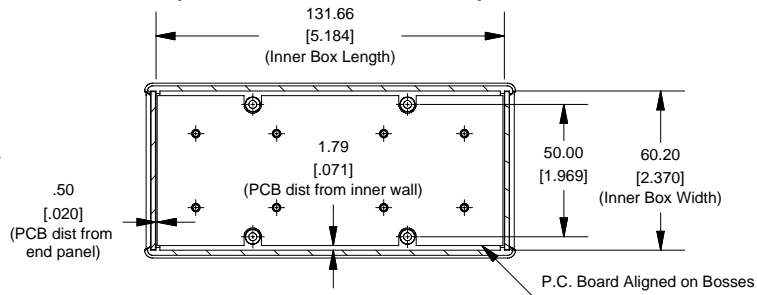

End View of Assembly

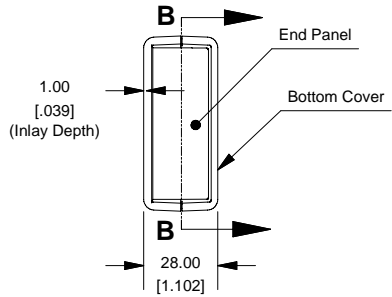

Front/Rear Panel (Dashed Line Indicates Viewing Area)

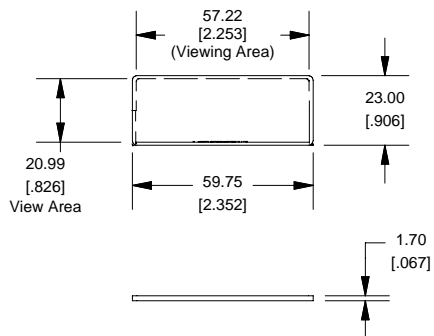

Maximum P.C. Board Size

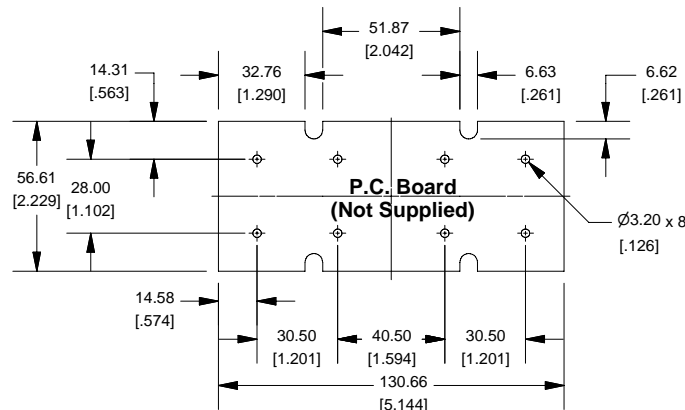

Hand Held Instrument (1593X)

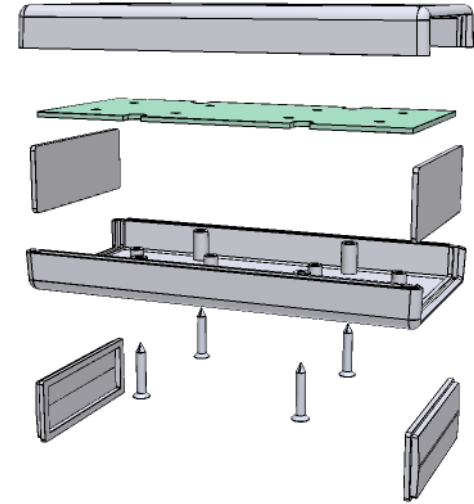

Enclosures can be Factory Modified (Milling, Drilling, Printing etc.)
Solid models of this enclosure available in STEP or IGES.
Contact Factory mjm@hammondmfg.com

NOTE

Enclosure molded from GP ABS (UL94-HB) plastic.
Purchased assembly includes top and bottom cover, front and rear plastic panels (2 types - flat and contoured) and 4 cover screws.

PART NUMBERS

1593X Enclosure	
Black Enclosure	1593XBK
Grey Enclosure	1593XGY
ACCESSORIES	
Cover Screws (Pkg 100) [#4 x 3/4" self-tapping oval head (19.1mm)]	1593QS100 (Silver) 1593QS100BK (Black)
P.C. Board Screws [#4 x 1/4" self-tapping (6.4mm)]	1593ATS50 (Pkg 50) 1593ATS100 (Pkg 100)
Belt or Pocket Clip	1599CLIP (Black) 1599CLIPGY (Grey)
Infrared Panels (Pkg 10)	1593DIR10

